



## T a p s

GARDEN - Design Piero Lissoni

Taps in AISI 304 stainless steel - Finish: grey PVD.

PVD = Physical Vapour Deposition.

Elements in PVD finish may present some tone differences. These issues cannot be considered cause for a complaint.

GARDEN - Top-mounted mixer tap for washbasin.

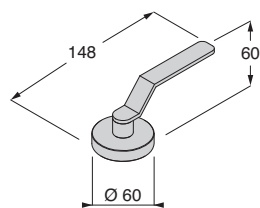

- Compatible with all top-mounted, wall or floor-mounted spouts.
- Progressive ceramic cartridge, 90° opening.

Grey PVD..... **REGN01**

GARDEN - Wall-mounted, built-in washbasin mixer tap.

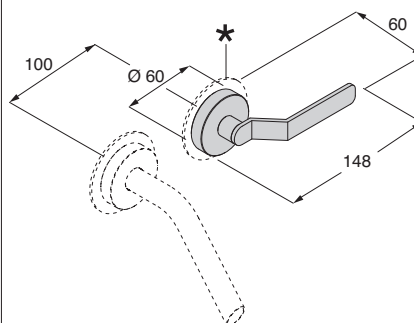

- Please order the spout (compulsory) separately.
- Compatible with all wall-mounted spouts.
- The spout must be ALWAYS installed on the left side of the mixer, as shown in the drawing.
- \* = the Ø 80 mm washer is included.
- Progressive ceramic cartridge, 90° opening.

Grey PVD, external part..... **REGN02E**

Recessed part..... **REGN02I**

GARDEN - Freestanding floor-mounted mixer tap for washbasin.

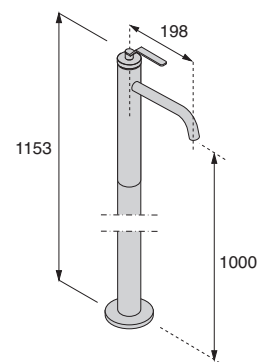

- Progressive ceramic cartridge, 90° opening.
- Flow rate: 4,5 l/min.

Grey PVD, external part..... **REGN03E**

Recessed part..... **REDM10I**

GARDEN - Top-mounted two handle tap for washbasin.

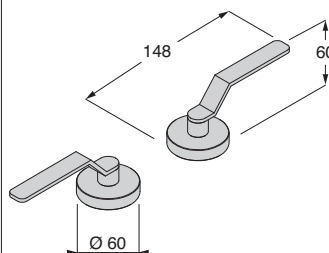

- Compatible with all top-mounted, wall or floor-mounted spouts.
- 1/2" ceramic screw disks, 90° opening.

Grey PVD..... **RGGN01**

GARDEN - Wall-mounted, built-in two handle tap for washbasin.

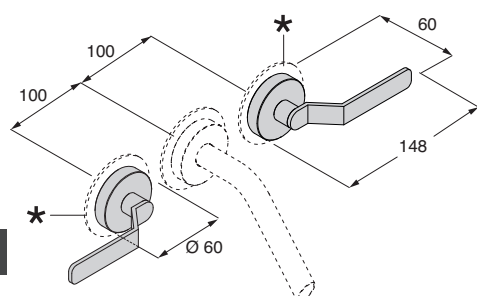

- Please order the spout (compulsory) separately.
- Compatible with all wall-mounted spouts.
- The spout must be ALWAYS installed as shown in the drawing.
- \* = the Ø 80 mm washer is included.
- 1/2" ceramic screw disks, 90° opening.

Grey PVD, external part..... **RGGN02E**

Recessed part..... **RGGN02I**

GARDEN - Wall-mounted, built-in mixer tap for washbasin / bidet / shower.

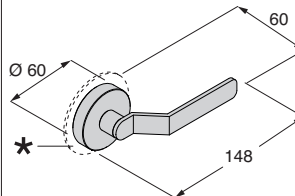

- Compatible with all top-mounted, wall or floor-mounted spouts.
- Compatible with all wall-mounted shower heads and hand-showers.
- \* = the Ø 80 mm washer is included.
- Progressive ceramic cartridge, 90° opening.

Grey PVD, external part..... **REGN04E**

Recessed part..... **REGN04I**

L = Width  
P = Depth  
H = Height  
Pr = Price code

## T a p s

GARDEN - Design Piero Lissoni

Taps in AISI 304 stainless steel - Finish: grey PVD.

PVD = Physical Vapour Deposition.

Elements in PVD finish may present some tone differences. These issues cannot be considered cause for a complaint.

**Pr**

GARDEN - Wall-mounted, built-in thermostatic mixer tap.

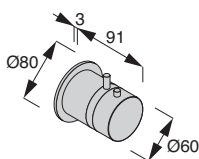

- Flow rate: 16,0 l/min.

Grey PVD, external part..... **REGN06E**  
Recessed part..... **RHRX03I**

GARDEN - Wall-mounted, built-in tap set for shower/bathtub.

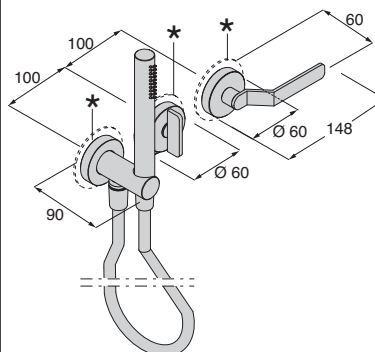

- Mixer tap with 90° progressive cartridge, 2-way diverter and hand-shower.
- Bathtub use: water supply to overflow.
- \* = the Ø 80 mm washer is included.
- Flow rate: 16,0 l/min.

Grey PVD, external part..... **RGGN03E**  
Recessed part..... **RGGN03I**

GARDEN - Wall-mounted, built-in tap set for shower.

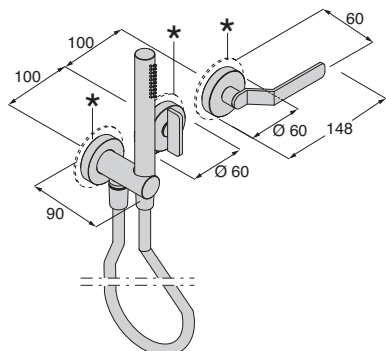

- Mixer tap with 90° progressive cartridge, 3-way diverter and hand-shower.
- \* = the Ø 80 mm washer is included.
- Flow rate: 16,0 l/min.

Grey PVD, external part..... **RGGN04E**  
Recessed part..... **RGGN04I**

GARDEN - Wall-mounted, built-in thermostatic tap set for shower.

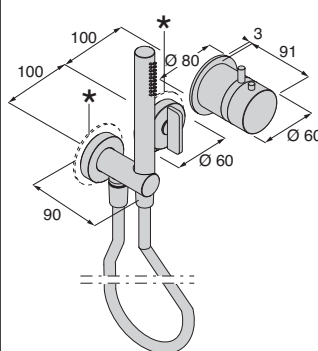

- Thermostatic mixer, 2-way diverter, hand-shower.
- \* = the Ø 80 mm washer is included.
- Flow rate: 16,0 l/min.

Grey PVD, external part..... **RHGN02E**  
Recessed part..... **RHGN02I**

GARDEN - Wall-mounted, built-in thermostatic tap set for shower.

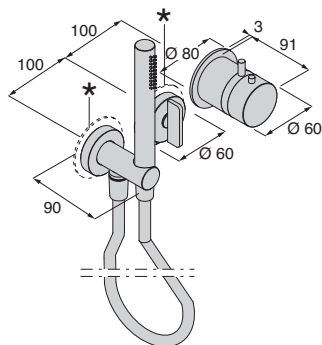

- Thermostatic mixer, 3-way diverter, hand-shower.
- \* = the Ø 80 mm washer is included.
- Flow rate: 16,0 l/min.

Grey PVD, external part..... **RHGN03E**  
Recessed part..... **RHGN03I**

GARDEN - Wall-mounted, built-in tap set for bathtub.

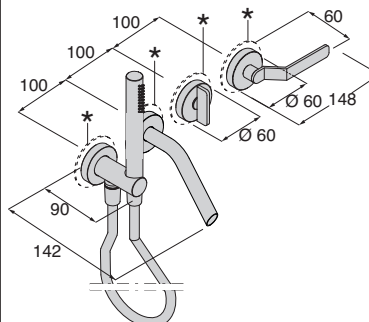

- Mixer tap with 90° progressive cartridge, spout, diverter and hand-shower.
- \* = the Ø 80 mm washer is included.
- Flow rate: 16,0 l/min.

Grey PVD, external part..... **RGGN07E**  
Recessed part..... **RGGN07I**

L = Width  
P = Depth  
H = Height  
Pr = Price code

T a p s  
GARDEN - Design Piero Lissoni

Taps in AISI 304 stainless steel - Finish: grey PVD.  
PVD = Physical Vapour Deposition.  
Elements in PVD finish may present some tone differences. These issues cannot be considered cause for a complaint.

GARDEN - Built-in deck-mounted tap set for bathtub.

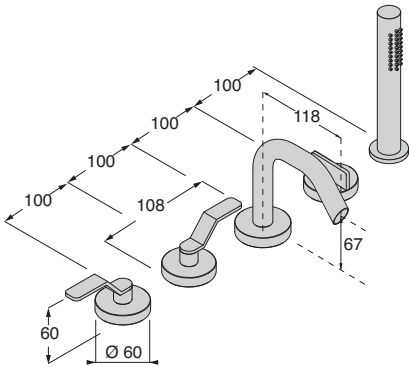

- Cold/warm taps, spout, hand-shower with its mixer.
- 1/2" ceramic screw disks, 90° opening.
- Flow rate: 20,0 l/min.

Grey PVD..... **RGGN05**

GARDEN - Built-in deck-mounted tap set for bathtub. Without spout.

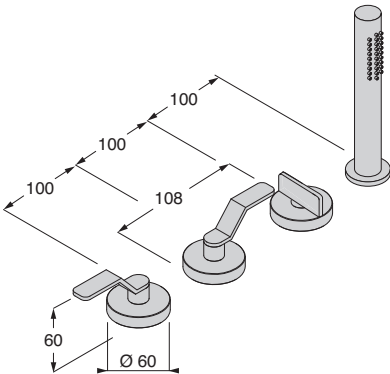

- Cold/warm taps, hand-shower with its mixer.
- 1/2" ceramic screw disks, 90° opening.
- Flow rate: 20,0 l/min.

Grey PVD..... **RGGN06**

GARDEN - Freestanding/floor-mounted bathtub tap set.

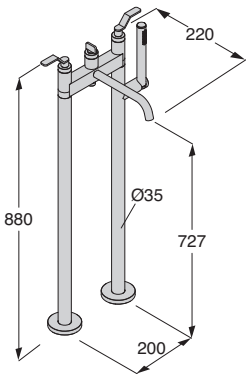

- Cold/warm taps, spout, diverter, hand-shower.
- 1/2" ceramic screw disks, 90° opening.
- Flow rate: 20,0 l/min.

Grey PVD, external part..... **RGGN08E**  
Recessed part..... **RGGN08I**

GARDEN - Wall-mounted spout for washbasin/bidet.

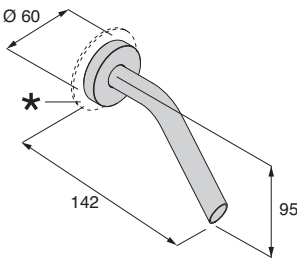

- \* = the Ø 80 mm washer is included.
- Flow rate: 4,5 l/min.

Grey PVD, P 128 mm..... **RIGN01**

GARDEN - Wall-mounted spout for washbasin.

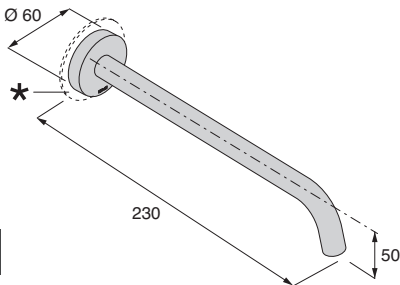

- \* = the Ø 80 mm washer is included.
- Flow rate: 4,5 l/min.

Grey PVD, P 230 mm..... **RIGN02**

GARDEN - Top-mounted spout for washbasin.

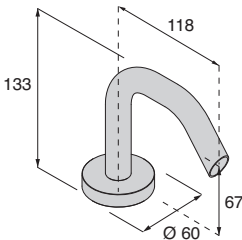

- Flow rate: 4,5 l/min.

Grey PVD, H 133 mm. .... **RIGN03**

Taps in AISI 304 stainless steel - Finish: grey PVD.  
PVD = Physical Vapour Deposition.  
Elements in PVD finish may present some tone differences. These issues cannot be considered cause for a complaint.

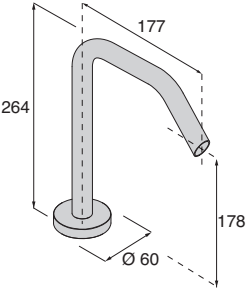
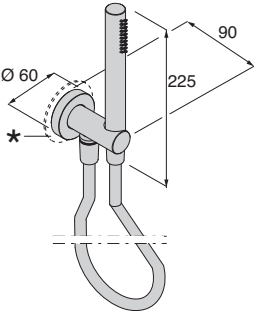
	Pr	
<p>GARDEN - Top-mounted spout for washbasin.</p>  <ul style="list-style-type: none"><li>• Flow rate: 4,5 l/min.</li></ul>		<p>GARDEN - Wall-mounted hand shower.</p>  <ul style="list-style-type: none"><li>• With 1500 mm long hose and water connection.</li><li>• * = the Ø 80 mm washer is included.</li><li>• Flow rate: 9,0 l/min.</li></ul>
Grey PVD, H 264 mm. ....	RIGN04	Grey PVD..... RJGN01